

LP Morgan **SkyHook** manual

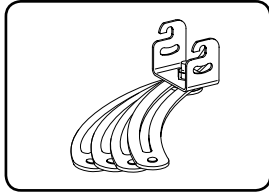

Unpacking the SkyHook

Parts supplied



Projector mounting assembly

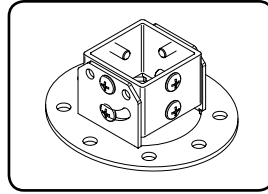

Ceiling mounting assembly

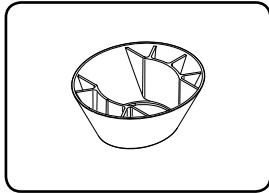

1 x Ceiling trim

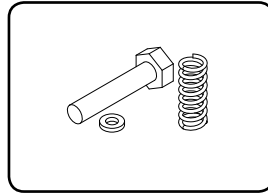

Assorted mounting bolts, springs and washers

Attaching the projector

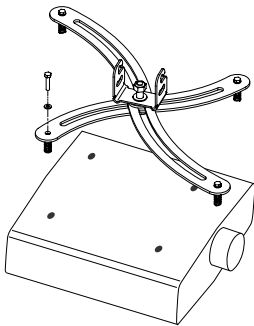

Loosen the centre bolt of the projector mounting assembly and splay the arms.

Mount the inverted projector to the arms with the supplied bolts washers and springs. Centralise the hook and tighten the bolts.

Intalliing the ceiling mount

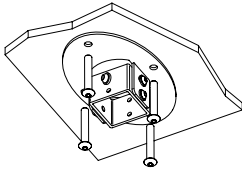

Secure the mounting assembly to the ceiling. Ensure it's aligned square with the projector direction.

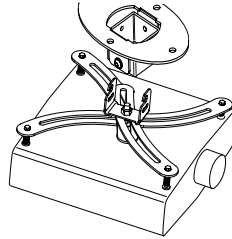

Hook the two assemblies together and reinsert the yaw adjustment screw

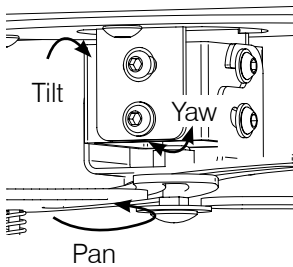

Align the projector using the pan, tilt and yaw adjustment.

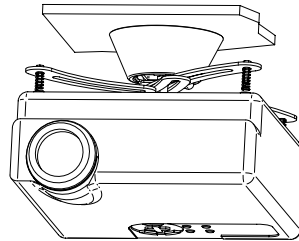

Open up the ceiling trim into a C shape and place around the ceiling mount

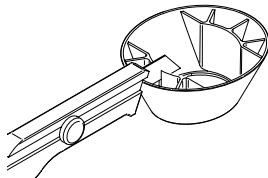

Cut the ceiling trim down one side.

**For more information on our range of products,
please visit www.lpmorgan.com.au, or contact
your local LP Morgan Retailer.**

Information in this document is subject to change without notice.

© Herma Technologies. All rights reserved.

This document is protected against unauthorised copying electronic or otherwise.

Trademarks used in this text: Herma, the Herma Logo, Galleria, LP Morgan and LP Morgan logo are registered trademarks of Herma Technologies.

Other trademarks and trade names used in this document remain the property of the relevant owners.

Factory 4a, 6 Albert Street Preston Vic 3072

Phone: +61 3 9480 6233 **Fax:** +61 3 9480 6533

Email: info@herma.com.au www.lpmorgan.com.au



October 2011 Version 4.3